

Mounting instructions

LAUDA Universa

Cylindrical insert

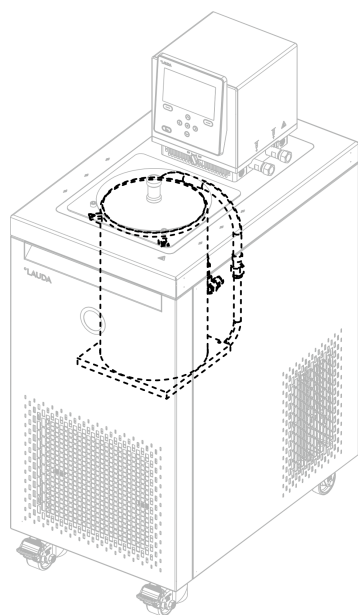

Manufacturer:

LAUDA DR. R. WOBSEER GMBH & CO. KG

Laudaplatz 1

97922 Lauda-Königshofen

Germany

Telephone: +49 (0)9343 503-0

E-mail: info@lauda.de

Internet: <https://www.lauda.de>

Q4WT-VT03-002, 1, en_US 04/27/2026 © 2026

Table of contents

1	Introduction.....	4
2	Safety instructions.....	6
3	Scope of delivery.....	8
4	Preparations.....	10
5	Installing the cylindrical insert.....	11
6	Filling and adjusting the insert.....	15

1 Introduction

These instructions describe the installation of the cylindrical insert in a LAUDA Universa MAX bath thermostat and are valid for the following accessory set. Read the instructions carefully before starting work.

Catalog number	Description
A001722	Cylindrical insert Compatible with U 2040 M and U 20 M

Intended use

This accessory set may only be operated under the conditions stated in the operating manual of the device. Any other use is considered improper. It is the operator's responsibility to ensure that the devices are used properly.

Accompanying documents

- Operating manual for Universa MAX and Universa PRO (Document number Q4DT-E_13-020)



The instructions, warnings and safety information in the operating manual must be followed when carrying out any work on the device that is required for the installation of the cylindrical insert and is dependent on the condition of the device.

Warranty conditions and disclaimer

LAUDA grants a standard warranty of one year. The components have been produced in compliance with high quality and safety requirements. Personal injury and material damage that are attributable e.g. to one or more of the following causes are excluded from the warranty and liability of LAUDA DR. R. WOBSE GMBH & CO. KG:

- Failure to follow these mounting instructions.
- Incorrect installation, commissioning, maintenance and operation.
- Improperly performed repairs and transport.
- Unauthorized structural changes to the device and accessories.
- Any damage caused by continued use in spite of an obvious defect.
- Non-use of genuine spare parts and accessories.
- Improper use of the device and accessories.

Personnel qualification

Specialized personnel

Certain activities on the device must be performed by specialized personnel. Specialized personnel are people whose professional education, knowledge, and experience as well as knowledge of relevant standards qualify them to assess the function and risks associated with the device and its use.

Protective equipment



Protective work clothing

Protective clothing is required for the work. This must meet the legal requirements for personal protective equipment. The protective clothing should be long-sleeved. Do not wear rings, chains or other jewelry.



Safety gloves



The safety gloves are used to protect against injury when removing the outer housing panels and when removing components. The safety gloves must be chemical-resistant for work involving possible contact with temperature control fluid.



Safety shoes

Safety shoes are used to protect against heavy falling parts and slipping on slippery surfaces. They are also used to protect the feet when removing the outer housing panels..

Structure of the warnings

Warning signs	Type of danger
	Warning – hot surface.
	Warning – danger zone.
Signal word	Meaning
WARNING!	This combination of symbol and signal word indicates a potentially dangerous situation that can result in death or serious injury if it is not avoided.
CAUTION!	This combination of symbol and signal word indicates a possible dangerous situation that can result in minor injury if it is not avoided.
NOTICE!	This combination of symbol and signal word indicates a potentially dangerous situation that can result in material and environmental damage if it is not avoided.
! NOTICE! Origin of the hazard	
Possible consequences of the hazard	
<ul style="list-style-type: none"> ● Measure 1 ● Measure... 	

2 Safety instructions



WARNING! Contact with live parts

Electric shock

- Disconnect the device from the power supply before performing any mounting work.



WARNING! Danger of the device rolling away or overturning

Impact, crushing

- Do not tilt the device!
- Position the device on an even, non-slip surface with a sufficient load carrying capacity!
- Actuate the caster brake when setting up the device!
- Do not place heavy parts on the device!



WARNING! Incorrect handling

Burning, fire, device damage

- Do not damage the cooling circuit.
- Do not use aggressive cleaners to clean the pump and control unit.
- Do not use chlorine-based cleaners for the bath vessel and evaporator.
- Do not use sharp or pointed objects to clean the evaporator.



CAUTION! Risk of hand and foot injuries!

When installing the jet pipe, there is a risk of hand injuries from sharp edges and crushing, as well as foot injuries when removing and attaching the pump and control unit.

- Geeignete Schutzhandschuhe, Arbeitsschutzkleidung und Sicherheitsschuhe tragen.
- Wear suitable protective gloves, protective work clothing, and safety shoes.
- Ensure that the work area is clean, well lit, and free of obstacles.
- Always position yourself and work in such a way that your hands and feet are not below the parts to be removed.



CAUTION!
Contact with hot / cold device parts, accessories and heat transfer liquid

Scalding, hot or cold burns

- Allow device parts, accessories and heat transfer liquid to reach room temperature before touching.

3 Scope of delivery

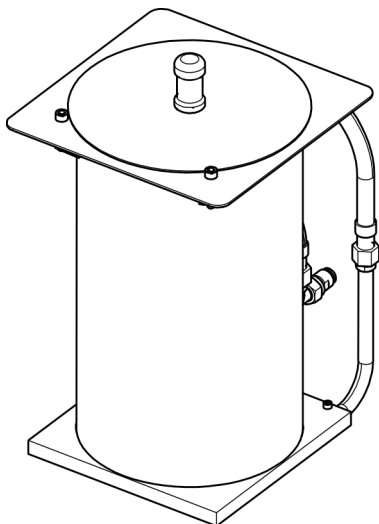
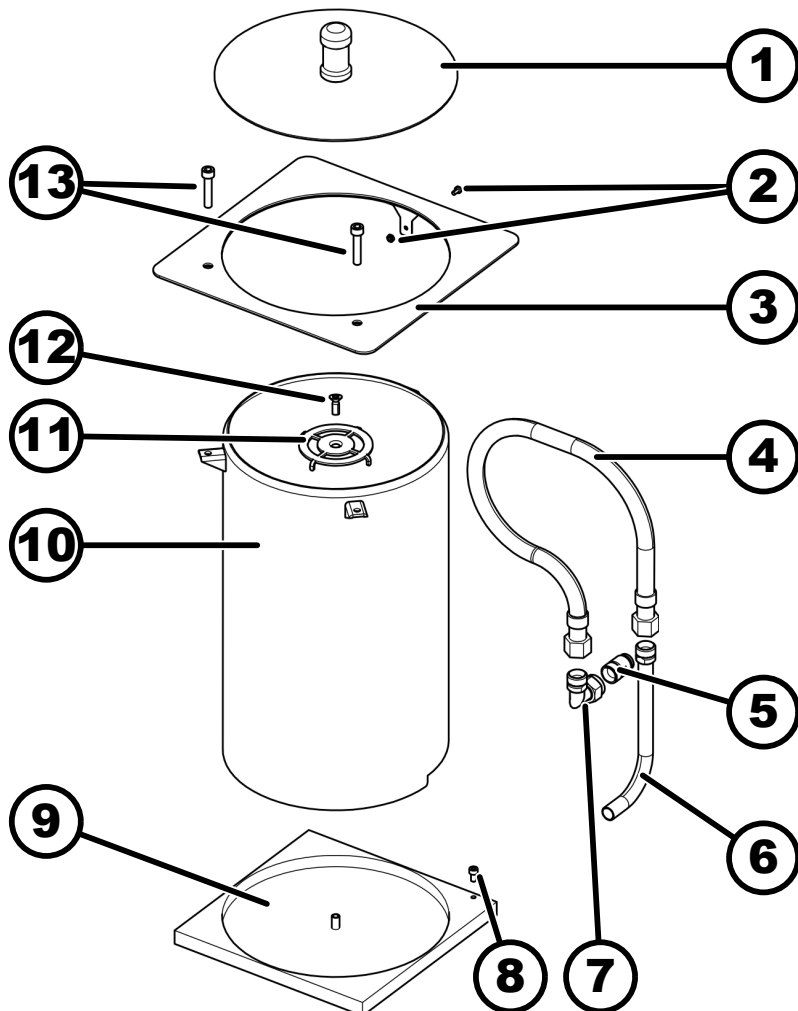

Fig. 1: Cylindrical insert, complete



No.	Quantity	Description
1	1	Cover
2	1	Fastening screw (M3x6) and hexagon nut for insert
3	1	Suspension plate
4	1	Stainless steel corrugated hose with union nuts
5	1	Threaded nipple for pump housing
6	1	Connecting pipe to the base plate
7	1	Angle adapter with union nut
8	1	Fastening screw (M4x8)
9	1	Base plate
10	1	Cylindrical insert
11	1	Baffle plate

No.	Quantity	Description
12	1	Fastening screw for baffle plate/insert (M5x14)
13	2	Adjusting screws for insert (M6x30)
-	1	Mounting instructions

4 Preparations

- Personnel: ■ Specialized personnel
- Protective equipment: ■ Protective work clothing
■ Safety gloves
■ Safety shoes
- Tool: ■ Allen wrench 3 mm
■ Allen key 4 mm
■ Allen wrench 5 mm
■ Crosshead screwdriver PZ2
■ Crosshead screwdriver PH2
■ Hexagon socket screwdriver TX10
■ Six-lobe screwdriver TX20
■ Six-lobe screwdriver TX25
■ Open-end wrench 5.5 mm
■ Open-end wrench 14 mm
■ Open-end wrench 19 mm
■ Water pump pliers

Mounting instructions

- Make sure that the device has been disconnected from the mains and secured against restarting.
- Make sure that the bath of the thermostat has been completely drained and that the bath and the pump and control unit are clean and dry.
- Place the device on a firm surface and make sure that there is sufficient free space for the dismantled pump and control unit.
- Check the scope of delivery of the accessory set for completeness and possible damage.
- No additional sealing material is required for the screw connections. The screw connections are tight, provided that the contact surfaces are clean and undamaged and installation has been carried out correctly.
- Tighten the screw connections until they are secure and cannot be easily loosened by hand. However, avoid continuing to turn with excessive force as soon as you feel significant resistance. The goal is to achieve tight, but not overtightened, screw connections.
- An FKM flange gasket (LAUDA catalog number: EDF 480) is installed on the bath bridge in the area of the locking bolts. When positioning the pump and control unit, make sure that the gasket is fitted correctly between the bath bridge and the pump and control unit.
- **Please note the following with regard to step ③ of the mounting instructions:**
Three screws are inserted through the pump housing from the bottom of the pump housing and screwed into spacer columns above the pump housing. When loosening these screws on the underside of the pump housing, the spacer columns above the pump housing must be held with water pump pliers and secured against turning.
- When installing the stainless steel corrugated hose in step ⑩, ensure that it does not rest on the mechanical components of the level indicator.
The screw connections of the stainless steel corrugated hose only need to be hand-tight.

5 Installing the cylindrical insert

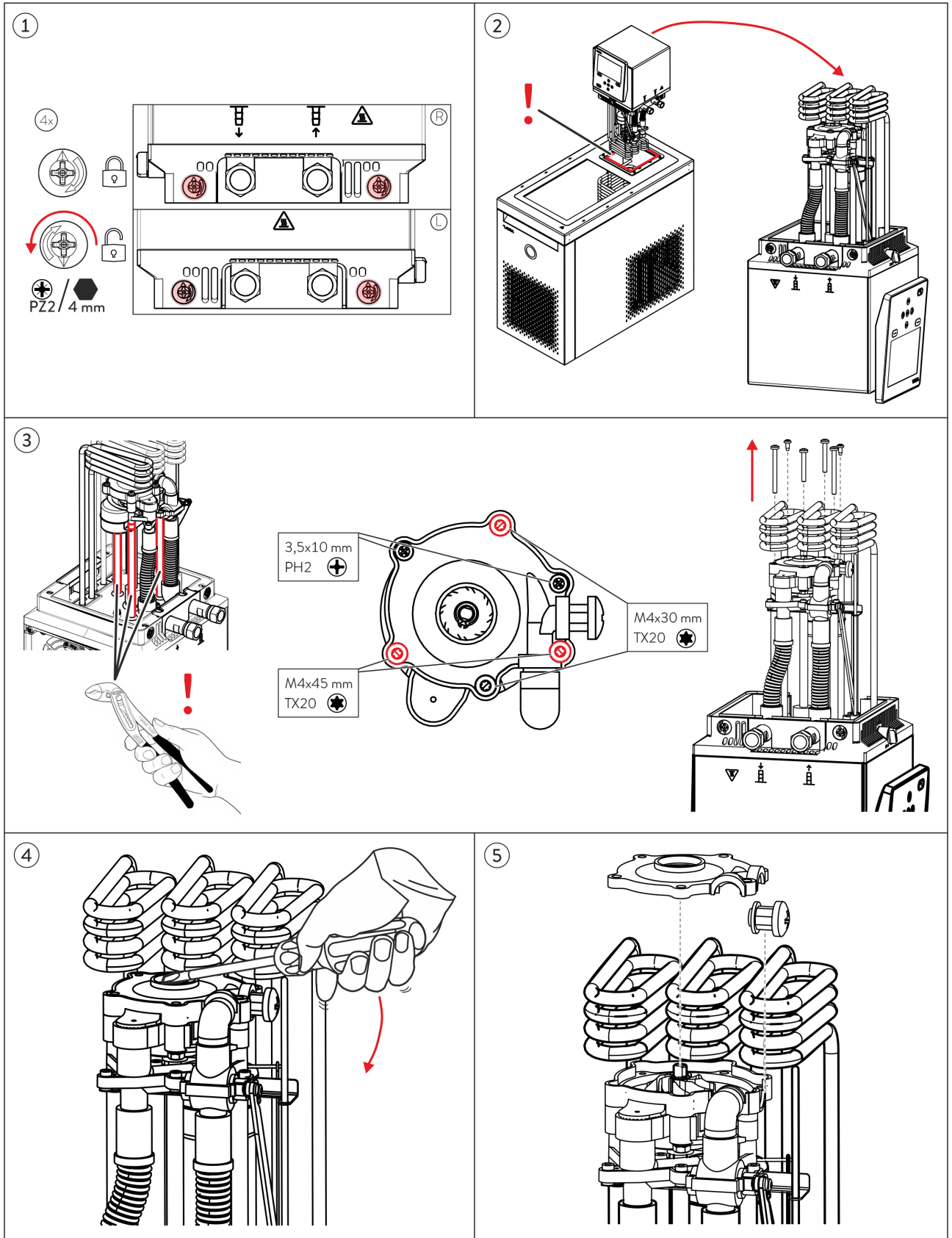

6

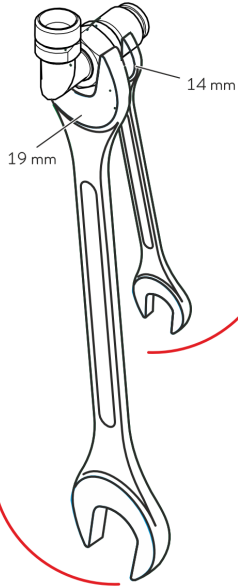
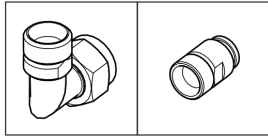

7

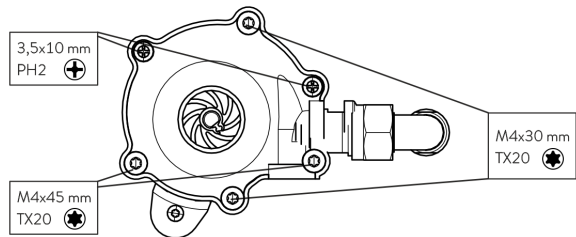
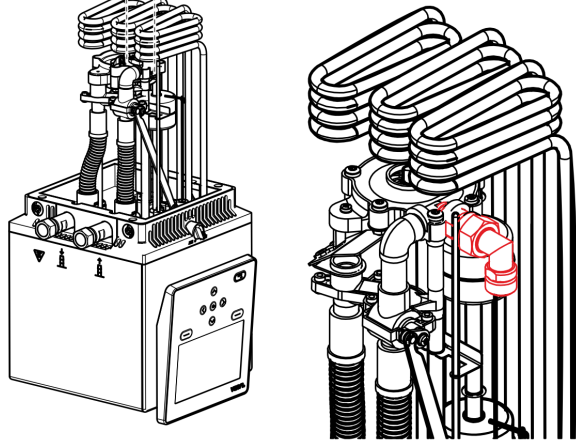
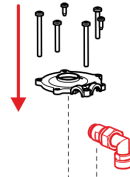

8

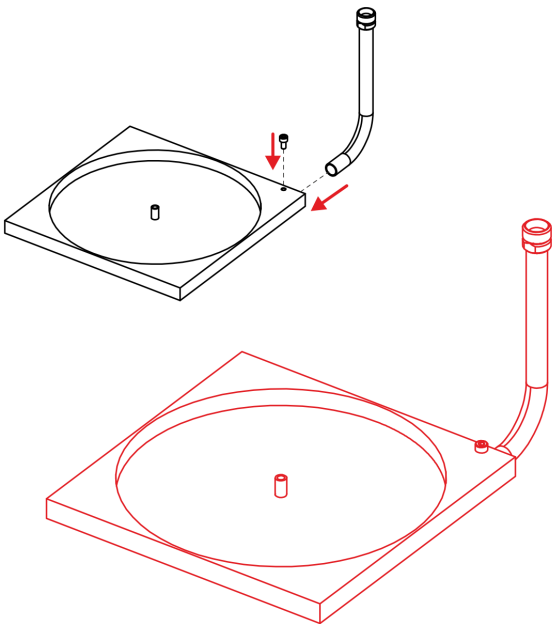
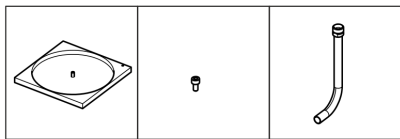

9

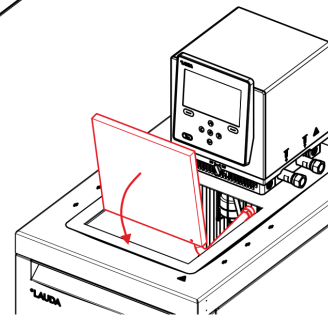
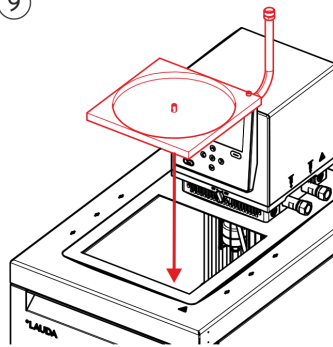

10

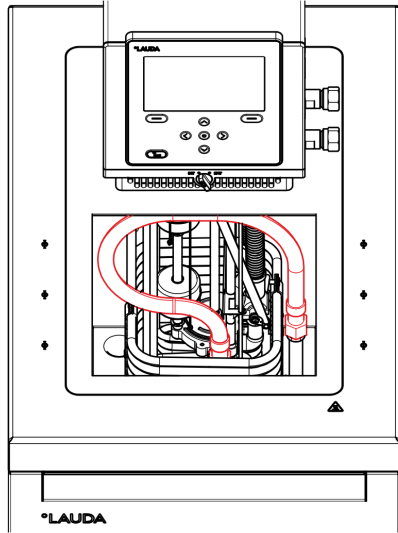
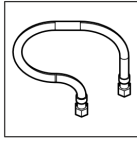

11

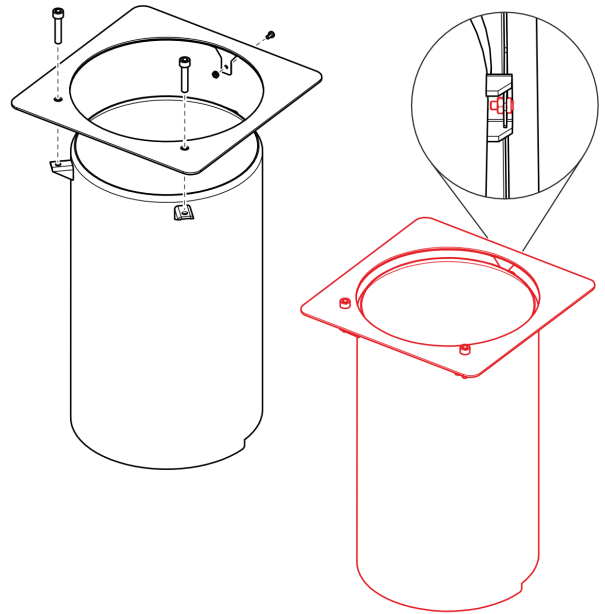
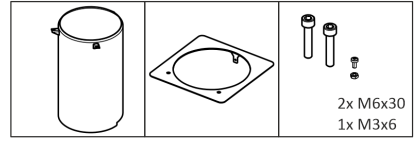

12

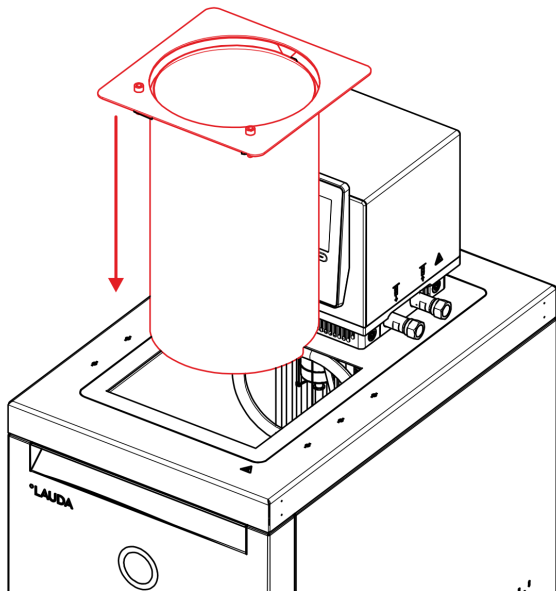

13

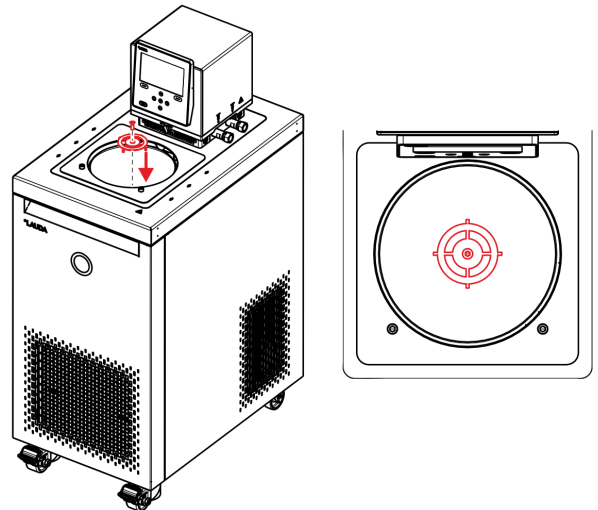
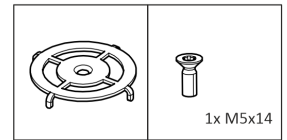

14

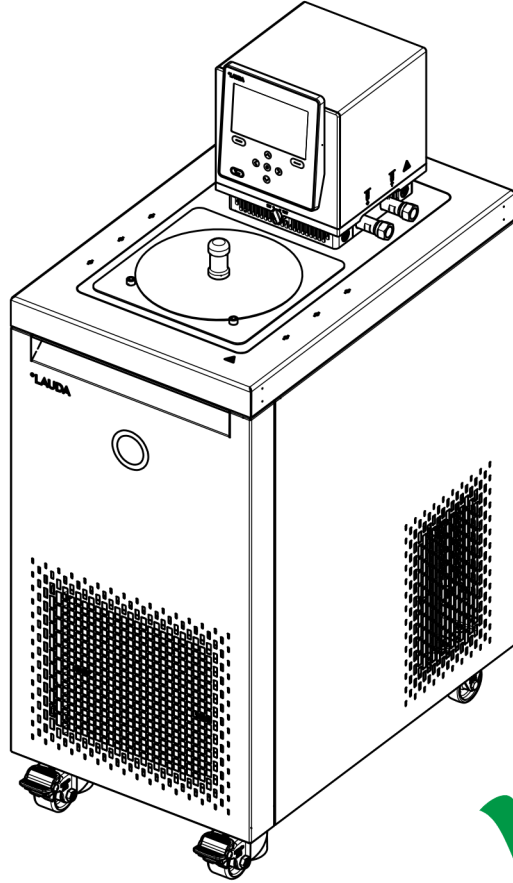

6 Filling and adjusting the insert



When commissioning the device with the insert installed, both the instructions below and the instructions, warnings and safety information in the relevant chapters of the operating manual must be followed at all times, see ↗ “Accompanying documents” on page 4.

Filling

After installation, you can fill the bath thermostat at room temperature via the cylindrical insert. Filling must be carried out slowly and gradually, since the liquid from the insert flows slowly into the remaining bath volume. Fill up to at least level 7 (of maximum 15). In the event of specified application temperatures higher than 100°C, the liquid will increase in volume. In the event of specified application temperatures lower than 20°C, you can fill up to level 13.

Switching on and adjusting

If required, you can use the two adjusting screws to level the cylindrical insert during commissioning.



Set the change-over switch for dividing the pump flow to “internal” before switching on the device. Make sure that the connections on the side for external applications are sealed with the screwed-on stoppers and union nuts.



Before filling, make sure that the basic settings have been configured on the device, see the chapter “Commissioning ⇒ Basic settings...” in the operating manual of the device.

After switching on, the liquid in the insert is pumped up, breaks at the edge and runs down the outside of the insert. This makes it easy to determine whether the cylinder insert has been installed straight or at an angle. If required, use the adjusting screws to make an adjustment and repeat the process until the cylinder insert has been correctly leveled.

The calibration rack must be correctly leveled for good homogeneity and stability values. Depending on the heat transfer liquid, the highest possible pump level should be selected.

Manufacturer:

LAUDA DR. R. WOBSE GMBH & CO. KG ° Laudaplatz 1 ° 97922 Lauda-Königshofen

Telephone: +49 (0)9343 503-0

E-mail: info@lauda.de ° Internet: <https://www.lauda.de>